

P.C.B. LAYOUT

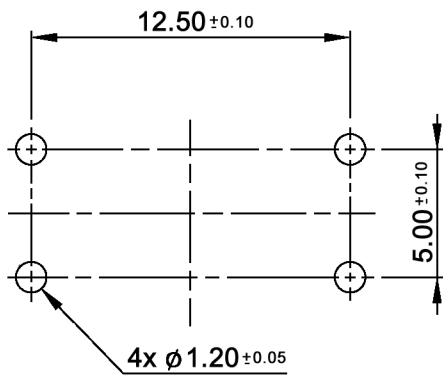

CIRCUIT DIAGRAM

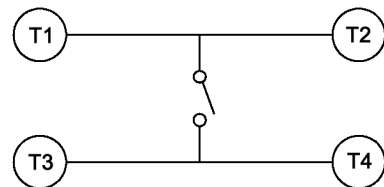

Compliance: RohS II (2011/65/EU)

Tolerances: ±0.20mm	Date	Name
	07/11	dr
Rename	08/14	dr
Modifications	Date	Name

**knitter-switch**

**TS 24 x**

**30 24 03**

Page

1/2

**Specifications:**

Contact rating: 50mA, 12V DC  
 Contact resistance: 100mOhm max.  
 Insulation resistance: 100MOhm min. at 500V DC  
 Dielectric strength: 250V, 50Hz for the duration of 1 minute  
 Operating temperature: -40°C to +85°C  
 Soldering conditions: hand-soldering: max.: 320°C, 2sec., 30W  
 auto-soldering: max.: 260°C, 5sec.  
 Travel: 0.35 +/-0.1mm  
 Mounting: on pc-board  
 Material: Contacts: phosphor bronze, silver plated  
 Terminals: PC terminals, brass, silver plated

x	Operating force (gf)	Stem color	Electrical life
N	160 +/-50	brown	200 000 cycles
R	260 +/-50	red	100 000 cycles
S	320 +/-80	salmon	100 000 cycles
Y	520 +/-130	yellow	100 000 cycles

Compliance: RohS II (2011/65/EU)

Tolerances: ±0.20mm		Date	Name	<b>TS 24 x</b>
		07/11	dr	
			<b>knitter-switch</b>	<b>30 24 03</b>
				2/2
Modifications	Date	Name		